

# The Execution of your Corona Vaccination Process on site

Please come to your vaccination appointment only if you feel healthy and if you do not have any symptoms of a respiratory infection or fever!

## Vaccination Center (Impfzentrum) Magdeburg

Messehalle 3  
Elbauenpark  
Tessenowstraße 9a  
39114 Magdeburg

### Opening hours:

Mondays: 08:00 a.m. - 12:00 p.m.  
Tuesdays: 08:00 a.m. - 12:00 p.m.  
Wednesdays: Closed  
Thursdays: 08:00 a.m. - 12:00 p.m.  
Fridays: 08:00 a.m. - 12:00 p.m.



Source: <http://google.de/maps>

### Access by public transport

Tramway lines: 5 or 6  
Bus line: 51  
→ Station: Messegelände / Elbauenpark

### Access by car

Please use the exhibition center parking lot (access via federal road B1).

### Have you thought of everything?

- Vaccination card – if not available, please provide a substitute certificate (<https://www.magdeburg.de/ErsatzbescheinigungSchutzimpfung>)  
(The substitute certificate for the vaccination documentation is used for patients who do not possess a vaccination card. It serves as an attestation of an implemented COVID-19 vaccination.)
- ID card
- Health insurance card (Patients who do not own an electronic health card also have access to the vaccination.)
- Information leaflet (<https://www.magdeburg.de/ImpfeinwilligungCorona>)
- Anamnesis and consent form (<https://www.magdeburg.de/AufklaerungImpfenCorona>)
- if necessary, write down open questions

### The process on site



Please be on time, but not too early.  
If necessary, you can bring an accompanying person.  
Please follow the signposted guidance system.

## Stations

## What is happening here?

- A

**Entry gate**

At the entry gate, fever measurement, security check, hand disinfection and, if necessary, handover of a face mask take place. Access is possible only individually, depending on the availability of the registration desk.
- B

**Reception**

The collection of your data takes place at registration booths. Please have your documents and your health insurance card at hand
- C

**Information**

At this station, you receive information on the upcoming vaccination. An information video is shown. Here you have the opportunity to ask general questions. Additionally, it is possible to have a confidential conversation with the vaccinator at the booth.
- D

**Vaccination**

After leaving the information station, you are sent along to a vaccination booth for the vaccination. Vaccination and documentation take place there. It is possible to ask questions to the vaccinator.
- E

**Waiting area**

For your own safety, it is necessary that you stay in the waiting area for 15 minutes after the vaccination. Meanwhile, your documents are completed.
- F

**Aftercare area and exit**

Here, your documents are given back to you. For today, you made it! Your second vaccination appointment is set up directly with you and should take place at the same time 21 days later, if possible.

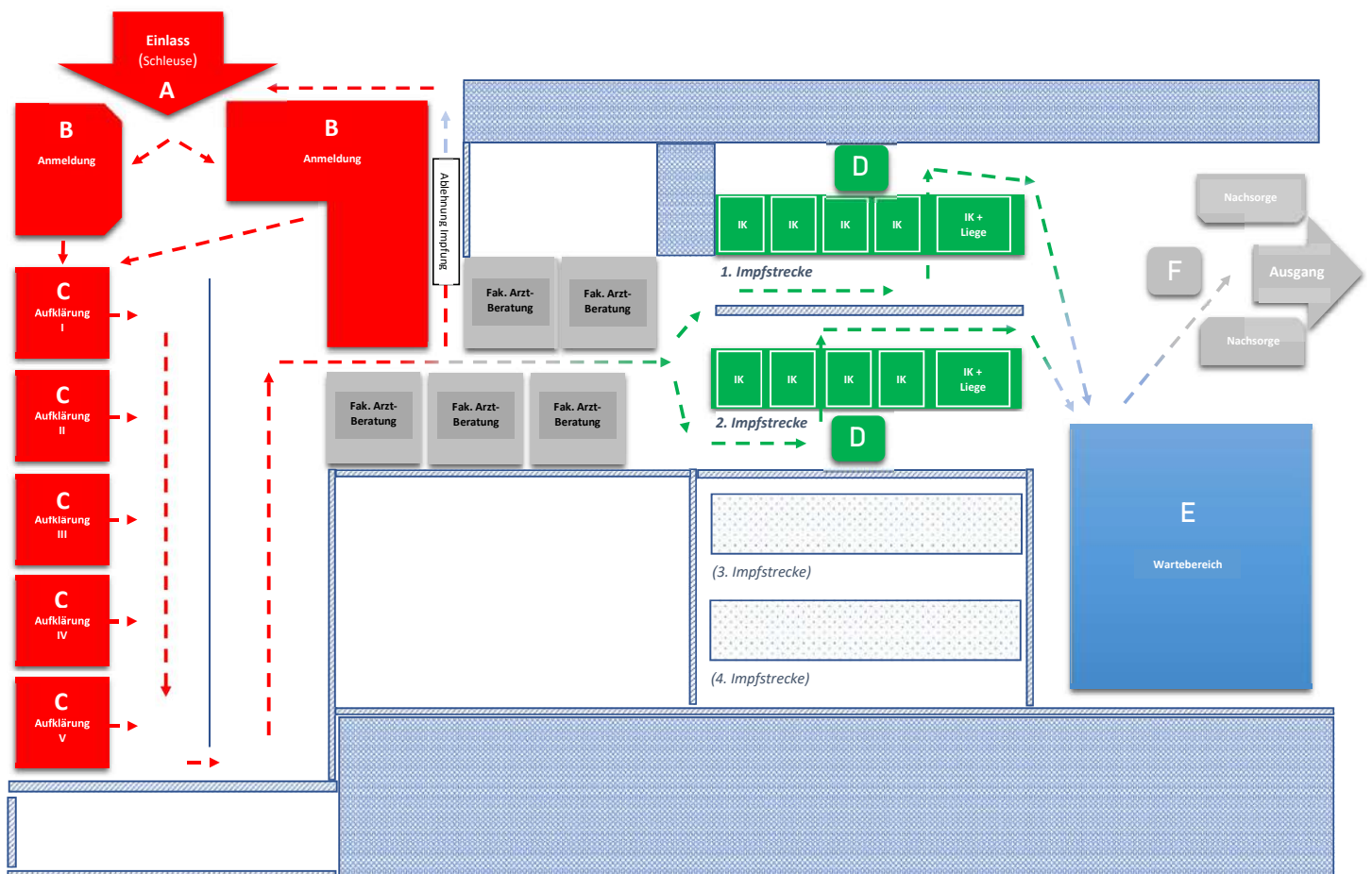

## **Please note**

Inside the vaccination center, strict hygiene rules are in place. Patients are required to wash their hands and to wear a face mask during the whole process. To avoid unnecessary contacts, it is mandatory to keep the appointments.

## **Corona vaccination in the city of Magdeburg**

The Corona vaccination is a so-called twofold vaccination. This means that a second vaccination at another appointment has to take place to ensure a complete vaccination protection. The appointment for the necessary second vaccination is allocated on site at Magdeburg vaccination center after the first vaccination.

The appointment allocation for the first vaccination takes place exclusively online via the vaccination portal of the city of Magdeburg.

Please plan approximately one hour for the vaccination appointment. Besides the examination of the vaccination entitlement, a consultation and a post-vaccination examination of the patients' well-being will be carried out.

## **Appointment booking**

(Attention - activation only after the arrival of further vaccination doses)

The criteria for the order of vaccination are defined by the standing vaccine commission (STIKO).

→ The final examination of your entitlement to a corona vaccination takes place on site at the vaccination center (exhibition center Magdeburg, hall 3).

## **The order of vaccination at a glance:**

### **Group 1 – Top priority**

- The over-80s
- People who are being treated, supervised or cared for, or who are working, in residential or semi-residential facilities or in residential groups receiving outpatient provision for treatment, supervision or care of elderly or care-dependent people.
- People who regularly perform protective vaccinations against coronavirus
- Care staff in outpatient care services and
- People who perform examinations and tests as part of outpatient care
- People who work in areas of medical facilities with a very high risk of exposure to coronavirus, particularly intensive care units, accident and emergency units, emergency services, specialist outpatient palliative care, vaccination centres and areas where aerosol-generating activities (e.g. bronchoscopy) are carried out
- People in medical facilities who regularly treat, supervise or care for people who have a very high risk of a severe or fatal disease progression after infection with coronavirus – particularly in oncology or transplant medicine, or in the course of treating severely immunosuppressive patients

## Group 2 – High priority

- The over-70s
- People with Trisomy 21 or a thalidomide disability
- People who have just had an organ transplant
- People with forms of dementia or mental disability, or severe psychiatric illnesses (bipolar disorder, schizophrenia, severe depression)
- People with cancers requiring treatment
- People with severe chronic pulmonary diseases (e.g. interstitial lung disease, COPD, cystic fibrosis), muscular dystrophy or comparable neuromuscular diseases, diabetes mellitus with complications, liver cirrhosis or other chronic liver diseases, chronic kidney disease or obesity (with BMI over 40)
- People who, according to an individual medical evaluation, have a very high risk of a severe or fatal disease progression after infection with coronavirus because of specific circumstances in their individual case
- Up to two close contacts of care-dependent people who do not live in an institution, are over 70 years old, have just had an organ transplant, or who have one of the above diseases or disabilities
- Up to two close contacts of pregnant mothers
- People who work in residential or outpatient facilities for mentally or psychologically handicapped persons, or who regularly treat, supervise or care for mentally or psychologically handicapped persons as part of outpatient care duties
- People who work in areas of medical facilities with, or who practise a healthcare profession that involves, a high or increased risk of exposure to coronavirus, in particular doctors and staff with regular patient contact and staff at blood/plasma donation facilities or coronavirus testing centres
- Police and emergency personnel who are exposed to a high risk of infection, for instance at demonstrations This also includes soldiers who are exposed to a high risk of infection in the course of overseas deployment
- People who work for the German Federal Republic diplomatic service or the German Archaeological Institute at places of work with inadequate health provision and who are exposed to a high risk of infection as a result
- People who work overseas for German political institutes or organisations and institutions headquartered in the German Federal Republic involved in the areas of crisis prevention, stabilisation, post-conflict rehabilitation, development cooperation or foreign cultural and educational policy, or in international organisations as German citizens in places with inadequate health provision, and who are exposed to a high risk of infection as a result
- People who work in childcare facilities, in child daycare, in primary schools, specialist schools or special needs schools
- People who work in the public health service and whose role is particularly relevant to maintaining hospital infrastructure
- People who are housed in or work in refugee and homeless person facilities in particular, or in other aid facilities for the homeless or women's shelters
- People who regularly work with elderly or care-dependent people as part of support services for everyday life recognised by state law, in the sense of § 45a of Book Eleven of the social security statute book



### **Group 3 – Heightened priority**

- The over-60s
- People with the following diseases in particular: cancers in remission not requiring treatment, immune deficiency or HIV infection, autoimmune diseases, rheumatological disorders, cardiac insufficiency, arrhythmia, stroke, asthma, chronic inflammatory bowel disease, diabetes mellitus without complications, obesity (BMI over 30)
- People who, according to an individual medical evaluation, have an increased risk of a severe or fatal disease progression after infection with coronavirus because of specific circumstances in their individual case
- Up to two close contacts of care-dependent people who do not live in an institution, are over 60 years old, or who have one of the above diseases
- People who are members of constitutional bodies or who work in particularly relevant positions in constitutional bodies, governments and administrations, who work for the police, customs service, fire service, disaster control including the Federal Agency for Technical Relief (Technisches Hilfswerk) or in law and justice, or who work overseas for the German diplomatic service, for German political institutes or organisations and institutions headquartered in the German Federal Republic involved in the areas of crisis prevention, stabilisation, postconflict rehabilitation, development cooperation or foreign cultural and educational policy, or who work in international organisations as German citizens
- Election workers
- People who work in particularly relevant positions in facilities and enterprises forming part of critical infrastructure, in particular pharmacies, the pharmaceutical industry, burial services, the foodstuffs industry, water and energy supply, wastewater disposal and the waste industry, transport and traffic or information technology and telecommunications
- Employees who work in areas of medical facilities with a low risk of exposure to coronavirus, in particular laboratories, and staff who have no patient care responsibilities
- People who work in the food retail sector
- People who work in childcare and youth welfare facilities and services, or at schools which are not primary, specialist or special needs schools, and who have a significantly increased risk of infection with coronavirus because of their living or working circumstances

### **Group 4 – No priority**

- All those who have little risk of suffering a severe covid-19 disease progression. These will be offered vaccination after the prioritised groups.